

ECO-CHARGE™ lantern

www.freeplayenergy.com

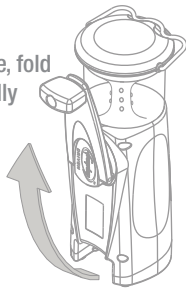

To self-charge, fold handle out fully



Wind handle clockwise or anticlockwise, illuminating the green LED

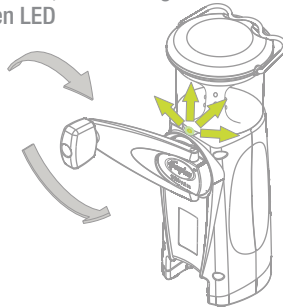

The Freeplay Indigo+ Eco-Charge LED Lantern, incorporating Freeplay's self-sufficient energy technology, is the most reliable and dependable lantern on the market.

With the Freeplay Indigo+ you've got light anytime, anywhere.

English

Controls:

1. Winder Handle
2. Ultra bright LED tower
3. Hanging/Carry Handle
4. Lens
5. Integrated directional LED
6. Control Panel:
 - A. On/Off/Dimmer Switch
 - B. Integrated directional LED Switch
7. External solar panel input socket
(Solar panel not included – available as an accessory)
8. USB Input Socket for charging the lantern
9. Emergency cellphone charging socket
10. USB compatible cable for emergency cellphone charging

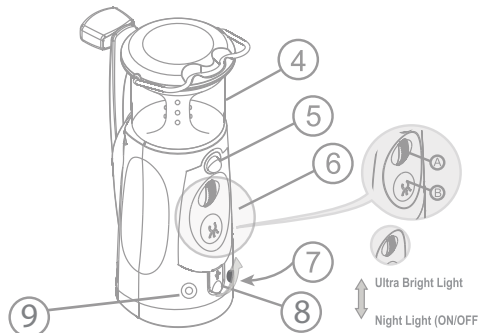
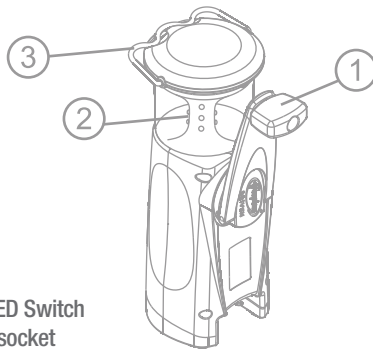

Congratulations on purchasing the Freeplay Eco-Charge Indigo+ lantern

Please read these operating instructions carefully before using your lantern and retain them for easy reference.

10. Emergency mobile phone charging

Emergency mobile phone charging is via a cable with a USB port. This allows the phone's own USB cable to connect to the lantern.



Emergency mobile phone charging only takes place when winding the handle at about 120 rpm. Mobile phone charging is not powered by the battery or a solar panel - it requires the correct operation and turning speed of the handle.

The brightness of the LED tower is controlled by a rotary dimmer switch and can be adjusted to give you the option of selecting any brightness – from night light to ultra bright. This unique feature lets you match your lighting requirements to your specific application, thereby maximizing your energy efficiency. The directional LED has a fixed brightness, and is independently controlled by the power switch below the dimmer switch. This LED can also

be used while the tower is on. The downward angle of the LED makes it an ideal task light for illuminating specific areas for reading or working, and can also be used as a handy flashlight.

Disposal of unit

Ni-MH batteries should be recycled or disposed of in an environmentally friendly way as prescribed by your local regulations.

FEATURES

- Micro USB recharge capability with internal rechargeable Ni-MH battery
- Freeplay direct charge generator
- 9 ultra-bright LEDs with dimmer switch control, never require replacement
- Adjustable brightness – from night light to ultra bright
- Integrated directional LED
- Solar panel input socket
- Emergency phone charging output socket
- USB compatible cable

PRECAUTIONS

- To prolong battery life, always switch the lantern off after use. A constant drain on a fully discharged battery will shorten the battery life.
- Do not open the casing other than when disposing of the unit.
- When cleaning do not use abrasives or chemicals. Only use damp cloth and mild detergents

SPECIFICATIONS

Power Source:

Self-charge: AC alternator driven by the crank via a transmission

Rechargeable Battery:

Non-removable rechargeable 3.6 V Ni-MH battery pack.

Light Source:

Ultra Bright white LED tower (9 LEDs)
10mm Single Ultra Bright white LED

Adapter Charge rate:

8 hours – 100% capacity

As a guide, a constant input effort of 40 minutes using the crank at optimum charge level would fully charge the battery.

Shine Time:

Multi LEDs

Fully recharged battery – 50 hours (night light)
Fully recharged battery – 3 hours (bright)
60-second self-charge – 2 hours (night light)
60-second self-charge – 5 minutes (bright)

Single LED

Fully charged – 25 hours
60-second self-charge – up to 1 hour

Dimensions: Metric (mm) Imperial (inches)

Height	205 (8)	Width	75 (2.9)
Length	70 (2.7)	Weight	450 g (1 lb)

OPERATION

External Charging

To charge from the wall, switch the lantern off. Insert the micro USB plug from a standard USB cable or adapter into the USB socket located below the control panel.

After approximately 8 hours, the lantern will be fully charged. The adapter can remain plugged in to provide a continuous trickle charge to the internal battery.

Self-charge Operation

To operate, hold the lantern firmly and crank the winder handle in any direction. A self-charge of about 30 seconds will provide up to 60 minutes of light at night light setting (low). The lantern can be cranked further at anytime to extend shine times. The Indigo+ lantern is equipped with a LED charge level indicator, situated above the winder handle, which signals when the optimum input effort is reached.

Cranking efforts in excess of this will provide a higher level of charge rate into the battery and consequently increase shine time.

Cranking the winder handle drives the internal alternator via a transmission, generating self-powered energy which is stored in the internal battery.

Solar Charging

Plug in a Freeplay Energy solar panel accessory (available online) or a 6V solar panel with a 1.3mm centre pin positive plug.

USB Charger

A standard 5V 500mA micro USB charging protocol means that one charger will now be able to charge most Freeplay products. You may already own a compatible charger (received with a mobile phone, PDA, or digital camera).

Emergency mobile phone charging

Indigo+ has an output power socket that can be used to recharge a mobile phone and other personal electronic devices in an emergency. Phone charging is achieved by a USB compatible cable which plugs into the lantern and connects to the phone's own USB cable.

Power for recharging a mobile phone is generated whilst cranking only. When the charging cable is inserted into the lantern socket, power created by cranking is diverted away from the lantern battery and into the phone. To maintain a stable power output, the handle should be wound at a constant speed with the green LED illuminated. As the phone accepts charge a resistance will be felt in the winding force. Once this load is experienced the handle should be turned at sufficient speed to maintain the charge delivery to the phone.

FREEPLAY 1 YEAR WARRANTY

The manufacturer undertakes that, if within 1 (one) year of purchase, this appliance or any part thereof is proved to be defective by reason of faulty workmanship of materials, we will, at our option, repair or replace the same, free of charge for labour or materials on condition that:

1. The original invoice or sales receipt (indicating the date of purchase, product type and dealer's name) is presented with the defective unit.
2. The complete unit is returned, postage paid, to the manufacturer or country distributor.
3. The unit has not been serviced, maintained, repaired, taken apart or tampered with by any person not authorised by the manufacturer.
4. All service work is undertaken by the manufacturer or appointed agents.
5. Any defective unit or part shall become the property of the manufacturer.
6. This warranty is in addition to your statutory rights.
7. This warranty excludes damage caused by misuse or neglect.

To learn more about Freeplay products, visit us at:

www.freeplayenergy.com

Please consider the environment before printing this manual.